

1. For information only.
2. Changes of material, design, process, tools or suppliers require approval by product development.
3. For unspecified form the 3D model is nominal.
4. Corrosion protection:
Zinc coated, DIN 50979-Fe//Zn8//Cn,
Colorless passivated, free of chromium-VI, salt spray test min.120h
5. Washers fixed with cable tier.

| Hardness | Hardness marking | Color dot | Vertical load Fz [N] | Vertical stiffness Cz [N/mm] ±20% |
|----------|------------------|-----------|----------------------|-----------------------------------|
| soft | S | Black | 400 | 125 |
| medium | M | Green | 700 | 225 |
| hard | H | Grey | 1100 | 350 |

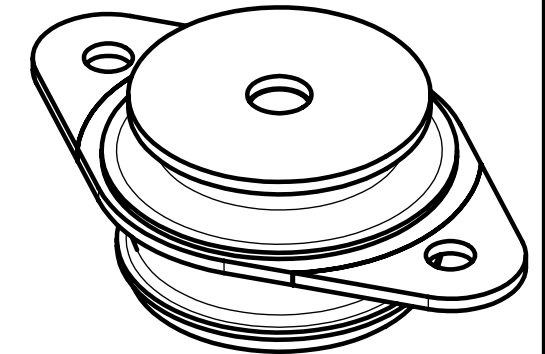

| Index | Changed | Date | Drawn | Checked | Approved |
|--|----------|------|---|--|----------|
| Math model reference: 786021-BI.2 | | | | | |
| Refer to protection notice ISO 16016 | | | General tolerances ISO 2768-mk ISO 3302-M3 | | |
| Tolerancing principle SIZE ISO 14405 (E) | | | Lengths, radii, chamfers | | |
| First angle projection ISO 5456-2 | | | Angles | | |
| Edges ISO 13715 | | | Straightness, flatness | | |
| Surfaces ISO 1302 | | | Circularity, circular/total runout | | |
| Surface calculated [mm ²] | | | Parallelism, perpendicularity | | |
| Volume calculated [mm ³] | | | Symmetry | | |
| Mould Number: 786021 | | | Code: | | |
| Scale: | Drawn | | R&D Changshu SolidWorks | Continental ContiTech Vibration Control Changshu | |
| 2:1 | Checked | | Format A3 | | |
| | Approved | | | | |
| Name: | | | Replace for: | | |
| Cone mount (Customer drawing) | | | Belongs to: | | |
| | | | Drawing no.: CN15-0495 | | |